

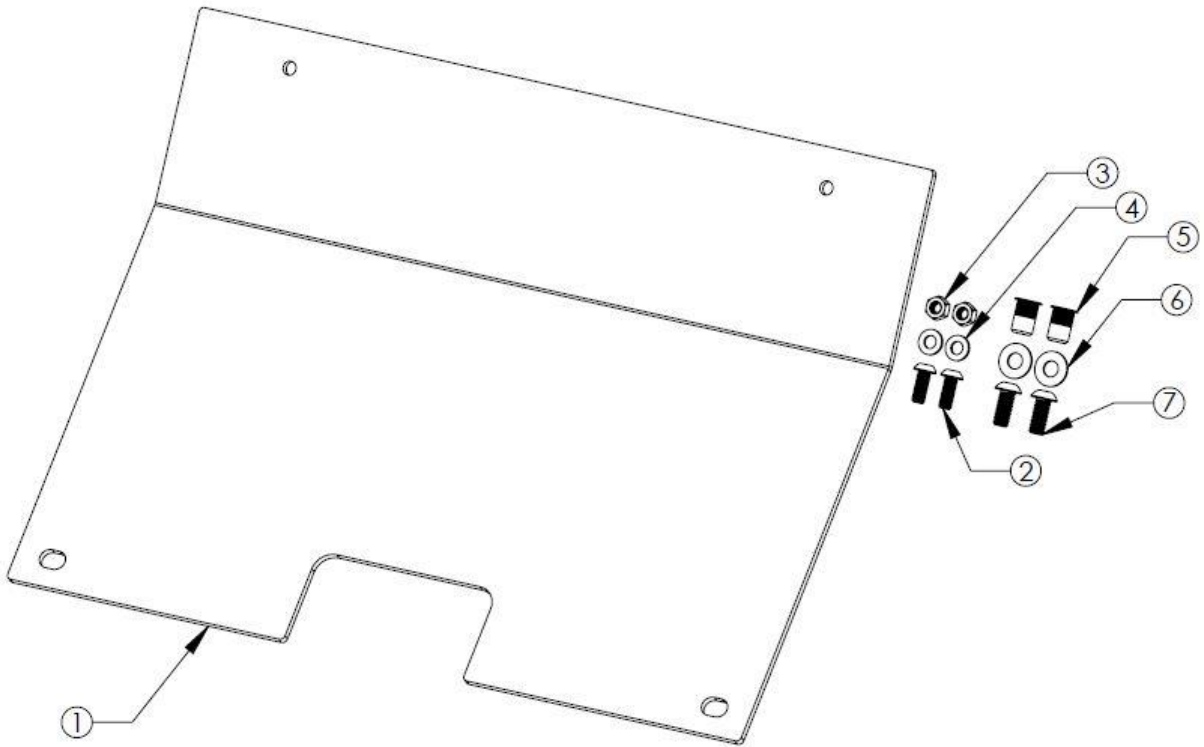

**79C27010**  
**aFe Power Terra Guard Skid Plate**  
**Subaru Outback 10-14**



Item	Description	P/N	Qty
1	Skid Plate, 10-14 Subaru Outback	05-61376	1
2	Button Head Screw: M8x1.25x25	03-50111	2
3	Nylon Lock Nut: M8 x 1.25	03-50244	2
4	Washer, Flat, M8	03-50159	2
5	Rivet Nut: 3/8-16	03-50569	2
6	Washer, Flat, 3/8	03-50230	2
7	Button Head Screw: 3/8-16 x 1-1/4	03-50827	2



- Please read the entire instruction manual before proceeding.
- Ensure all components listed are present.
- For technical support please call 951-493-7185.
- Ensure you have all necessary tools before proceeding.
- Retain factory parts for future use.

**Recommended Tools & Equipment:**

- Floor ramps or 4-post lift, Rivet Nut Installation tool

Warranty Information available at <https://afepower.com/contact#warranty>

**Procedure:**

1. This installation can be done with the vehicle on the ground. But, for an easier installation, drive the vehicle onto floor ramps or 4-post rack.





2. Install Rivet Nuts in the center two subframe holes.





3. Install 79C27012 Skid Plate using the (2) 3/8-16 Bolts, (2) 3/8 Washer, (2) M8 Washer, (2) M8 Bolts, & (2) M8 Nuts.

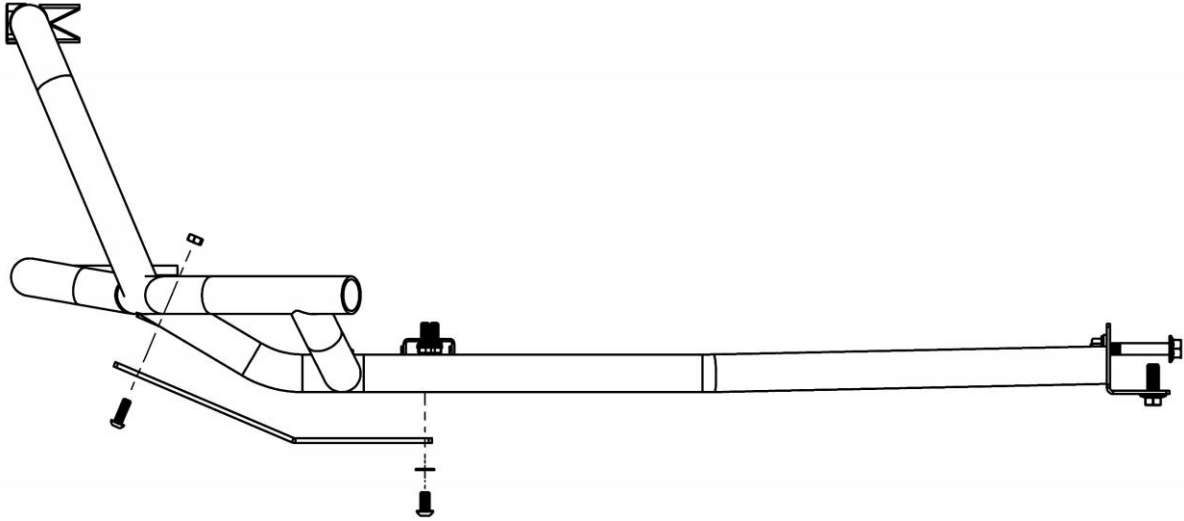



*advanced FLOW engineering, inc.*