

advanced FLOW engineering Cold Air Intake System

Instruction Manual P/N: 54-13069D / 54-13069R

Make: Ford
Make: Ford

Model: Super Duty F-250
Model: Super Duty F-350

Year: 2020-2022
Year: 2020-2022

Engine: V8-7.3L
Engine: V8-7.3L



- Please read the entire instruction manual before proceeding.
- Ensure all components listed are present.
- For technical support please call 951-493-7185.
- Ensure you have all necessary tools before proceeding.
- Do not attempt to work on your vehicle when the engine is hot.
- Retain factory parts for future use.

Label	Qty.	Description	Part Number
A1	1	Air Filter (Pro 5R)	24-91120
A2	1	Air Filter (Pro DRY S)	21-91120
B	1	Tube	05-5413069B1
C	1	Housing	05-5413069B2
D	1	Coupling, Silicone Bellows	05-01600
E	2	Clamp, 072 (3" - 5")	03-50010
F	2	Screw, Torx: M4x10mm	03-50490
G	1	Seal Trim, Scoop	05-01553
H	4	Retainer Clip	05-01554
J	1	Seal, Trim: 3/4" Bulb (31"L)	05-01507

Installation will require the following tools:

Panel clip remover, T20 Torx driver, 7mm & 8mm nut drivers

Warranty Information available at <https://afepower.com/contact#warranty>

Emissions Disclaimer: This product is not currently CARB exempt and is not available for purchase in California or for use on any vehicle registered with the California Department of Motor Vehicles.

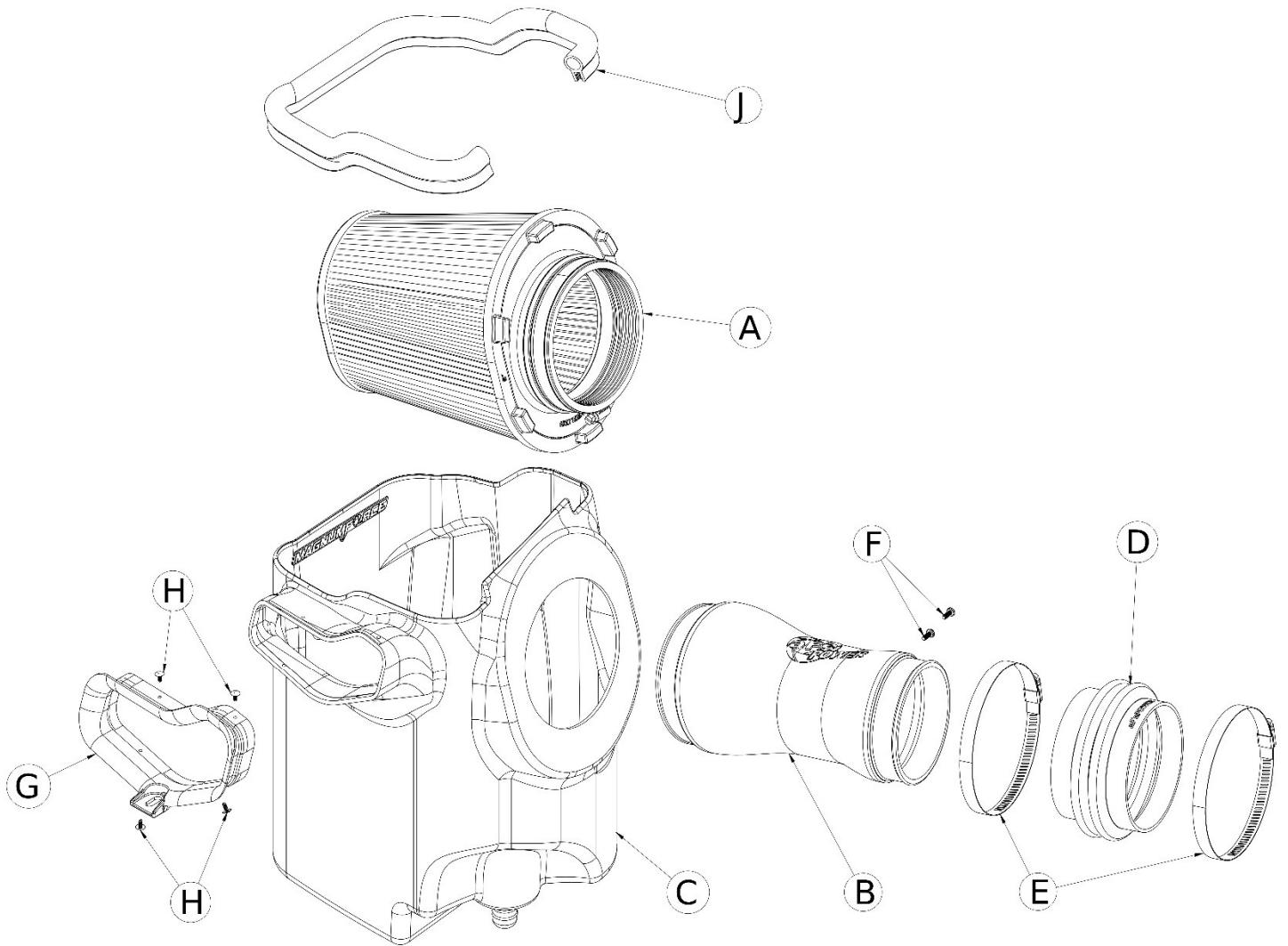

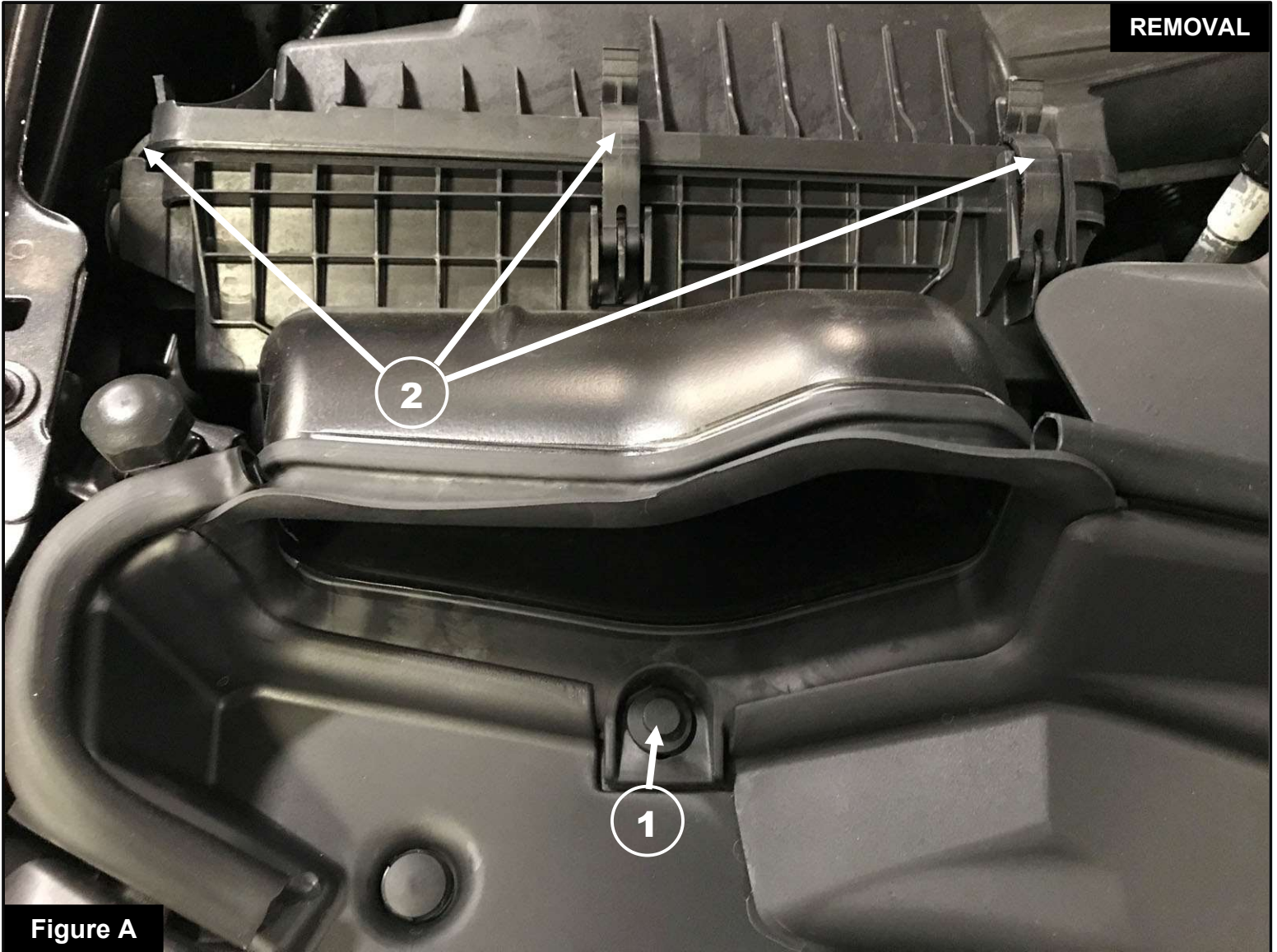
**Figure A****Refer to Figure A for Steps 1-2**

Step 1: Using a panel clip remover, remove the retaining plastic clip ① holding part of the scoop seal down, and set it aside for later use.

Step 2: Unclip the three taps ② from the factory air filter cover.

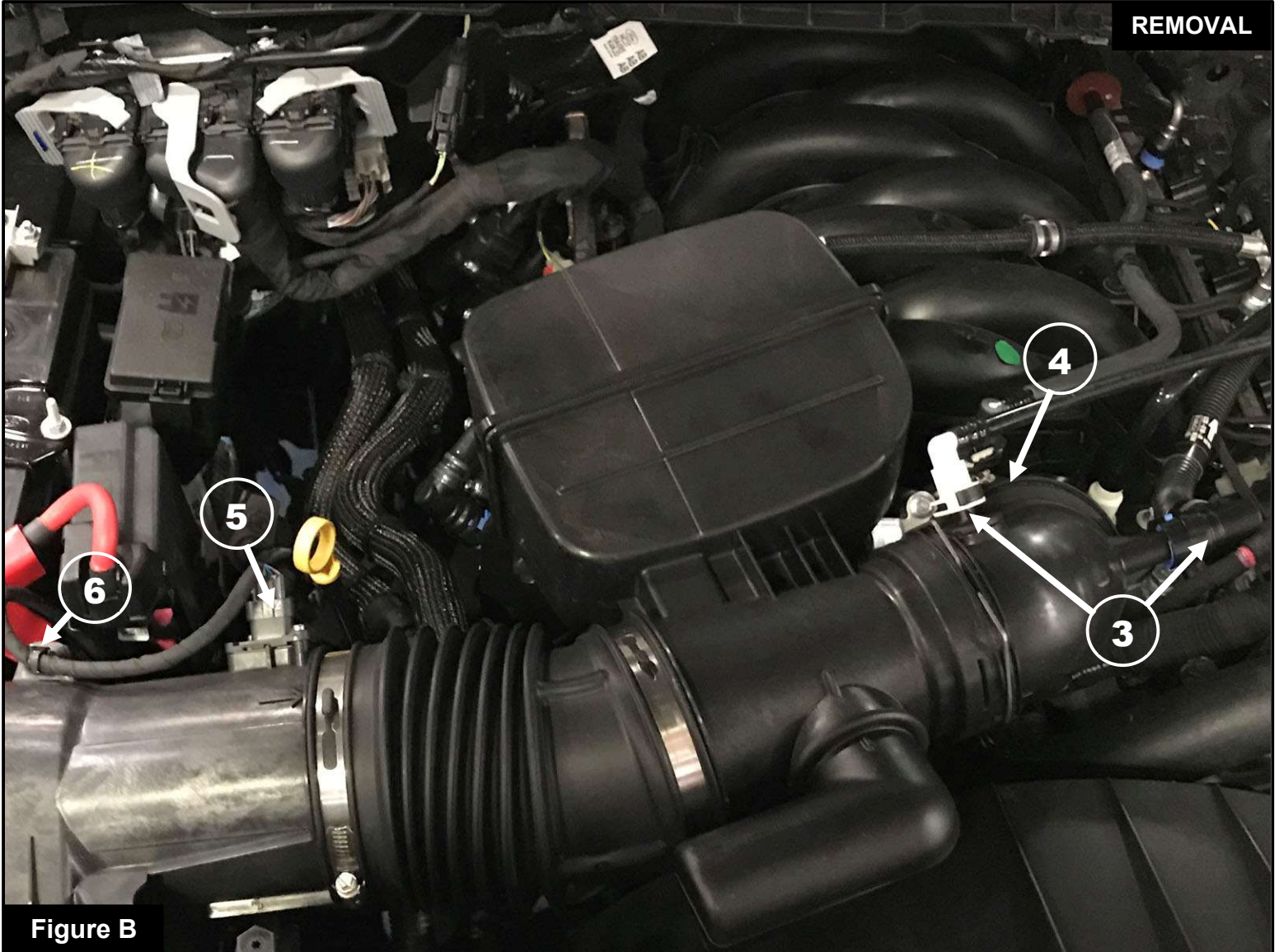
**Figure B****Refer to Figure B for Steps 3-6**

Step 3: Disconnect the two quick disconnect fittings (3) from the factory intake tube.

Step 4: Using a 7mm nut driver, loosen the hose clamp (4) at the throttle body.

Step 5: Disconnect the MAF sensor (5) and the clip (6) holding the harness.

Step 6: Remove the factory air filter cover/intake tube assembly and set it aside.



Refer to Figure C for Step 7

Step 7: Remove the factory lower air filter housing by pulling it straight up from its mounting grommets.

**Figure D****Refer to Figure D for Steps 8-9**

Step 8: Place the scoop seal trim (7) on the scoop opening of the aFe POWER housing.

Step 9: Align the holes from the scoop seal trim and the aFe POWER housing. Insert all four retainer clips (8) fully into the cavities and ensure the seal trim is securely attached to the aFe POWER housing.



Figure E

Refer to Figure E for Step 10

Step 10: Remove the two grommets ⑨ from the factory lower air filter housing and install them onto the aFe POWER housing. Make sure they are fully seated past the bead.

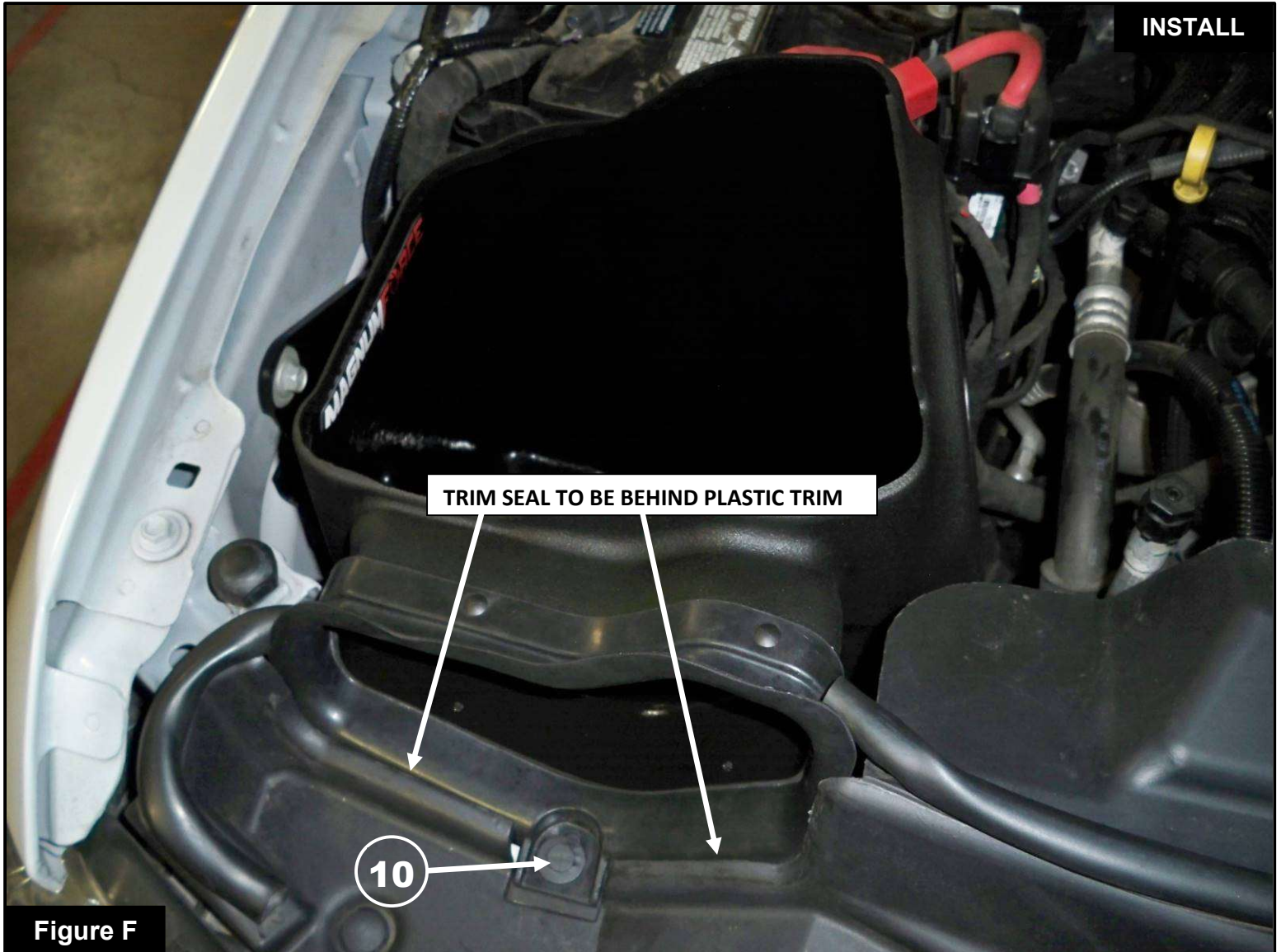

Refer to Figure F for Steps 11-12

Step 11: Install the aFe POWER housing on to vehicle. Ensure the bottom mounting pin is fully seated in the mounting grommet, and that the two side mounting pins with grommets are fully engaged with the mounting bracket.

Step 12: Ensure the scoop seal trim is seated behind the plastic trim cover (please see picture). Install the retaining plastic clip (10) removed on step 1 to secure the trim seal.

**Figure G****Refer to Figure G for Steps 13-14**

Step 13: Remove the filter clamp (11) from the aFe POWER filter. Slide the aFe POWER filter into the aFe POWER housing from the top. Then guide the filter flange through the round opening in the housing and snap in the filter. Place the filter clamp on the filter flange.

Step 14: Install the seal trim (12) on the top opening of the housing as shown.

**Figure H****Refer to Figure H for Step 15**

Step 15: Using a T20 Torx driver, remove the MAF sensor (13) from the factory air filter cover and install it on the aFe POWER intake tube using the supplied M4 screws.

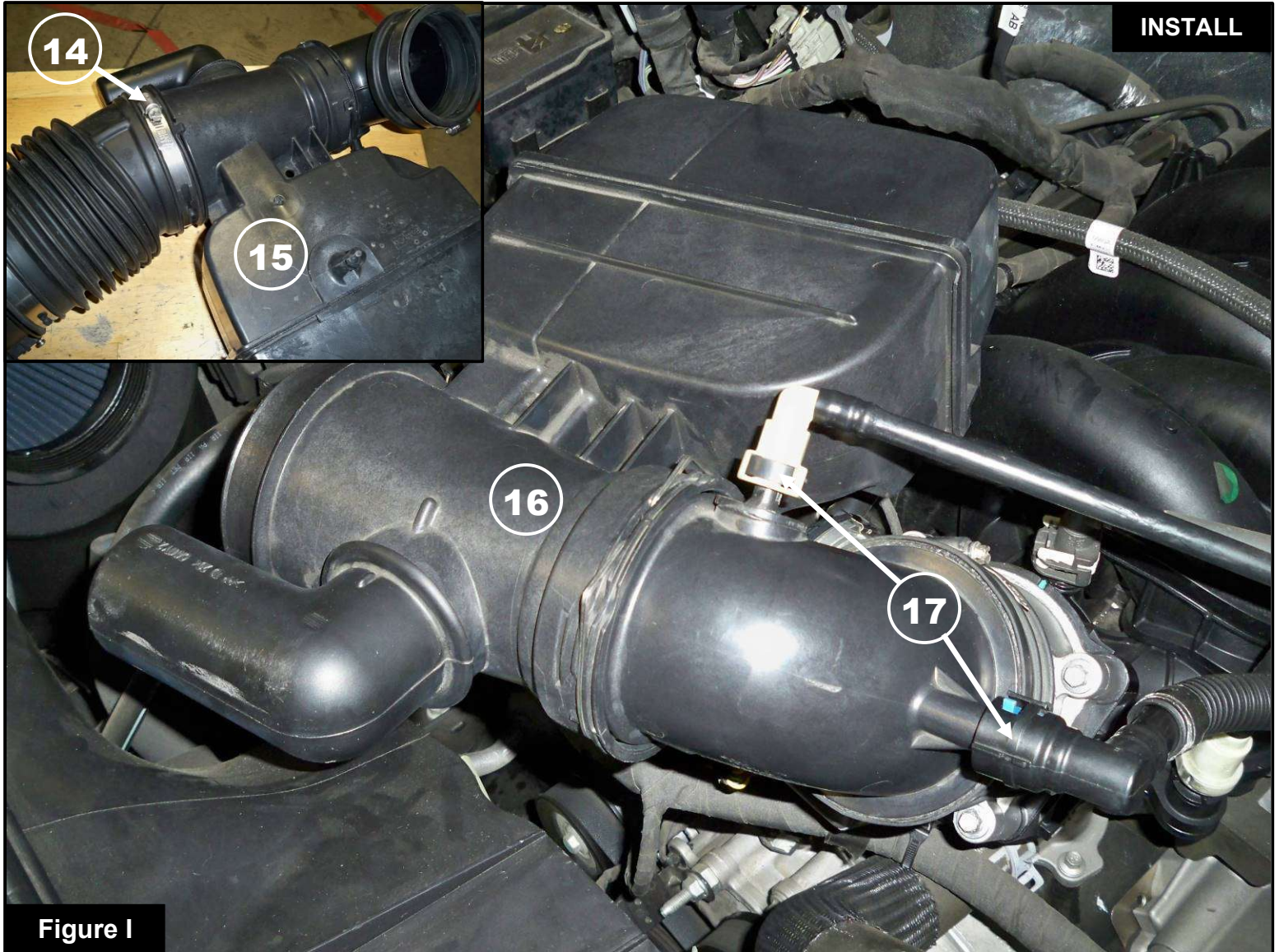

Refer to Figure I for Steps 16-18

Step 16: Using a 7mm nut driver, loosen the hose clamp ⑭ closest to the air resonator ⑮ as shown, and separate the factory intake tube.

Step 17: Reinstall the resonator section ⑯ back into the vehicle.

Step 18: Reconnect the two quick disconnect breather connectors ⑰.



Figure J

Refer to Figure J for Steps 19-20

Step 19: Place the supplied aFe POWER coupling (18) and a #072 clamp (19) on the factory tube. Place the other #072 clamp (20) on the installed coupling.

Step 20: Install the aFe POWER intake tube into the vehicle. Slide the tube into the coupling first, then into the air filter. Align the coupling, then using an 8mm nut driver, tighten all the clamps.

**Figure K****Refer to Figure K for Steps 21-22**

Step 21: Reconnect the MAF sensor ②1.

Step 22: Check all the components are tight and secure. Your installation is now complete. Thank you for choosing aFe POWER!

NOTE: Check all bolts, clamps, and connectors after 100-200 miles.



Page left blank intentionally



advanced FLOW engineering, inc.

252 Granite Street Corona, CA 92879

<https://afepower.com/contact>