

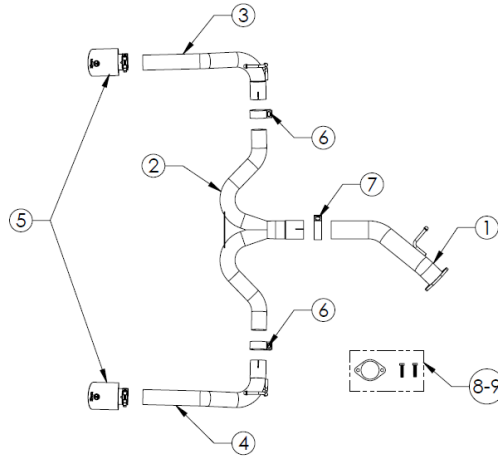

INSTALLATION INSTRUCTIONS

MAKE: Kia
MODEL: Forte GT
YEAR: 2020-2021
ENGINE: L4-1.6L (t)

Axle-Back Exhaust
 49-37037-B (Black Tips)
 49-37037-P (Polished Tips)
 49-37037-C (Carbon Tips)
 49-37037-L (Blue Flame Tips)



Item	Description	Part Number	Quantity
1	Mid-Pipe Assembly #3	05-145419	1
2	Y-Pipe Assembly	05-145420	1
3	Tail-Pipe Driver Side	05-244567	1
4	Tail-Pipe Passenger Side	05-244568	1
5	EXH Tip 2-1/2 In x 4 Out x 8L Bolt-On Blk	49T25404-B08	2
5	EXH Tip 2-1/2 In x 4 Out x 8L Bolt-On Pol	49T25404-P08	2
5	EXH Tip 2-1/2 In x 4 Out x 7L Bolt-On Blue Flame	49T25404-L07	2
5	EXH Tip 2-1/2 In x 4 Out x 7L Bolt-On Carbon	49T25404-C07	2
6	2-1/2" Band Clamp	05-41061	2
7	3" Band Clamp	05-41055	1
8	Screw, SHCS: M12 x 1.25 x 50mm	03-50582	2
9	Gasket, Exhaust 2-Bolt: 3.00 ID x 4.00 BC	05-46300	1

aFe POWER recommends professional installation on this product. Thoroughly inspect the aFe POWER exhaust system to make sure there is no damage from shipping (if damage is noted, immediately contact aFe POWER customer service). Allow time for your vehicle to cool down prior to installation. When working on your vehicle proceed with caution. Wear protective safety equipment; eye goggles and gloves to ensure a safe installation.

Install band clamps to proper torque specifications of 40-45 ft-lb.





INSTALLATION INSTRUCTIONS

MAKE: Kia
MODEL: Forte GT
YEAR: 2020-2021
ENGINE: L4-1.6L (t)

Axle-Back Exhaust
49-37037-B (Black Tips)
49-37037-P (Polished Tips)
49-37037-C (Carbon Tips)
49-37037-L (Blue Flame Tips)

1. **(Read instructions prior to installation.)** It is recommended to not fully tighten the exhaust until it has been fully installed. Leave loose for adjustability.
2. Secure vehicle on jack stands (refer to your manual for specified jack stand positions).
3. For faster installation, spread out the parts of the exhaust alongside your vehicle as shown in the diagram above.
4. Secure the stock exhaust with jack/stands.
5. Remove the stock axle back exhaust by unbolting it from the first flanged joint and removing it from the stock rubber isolation mounts.
6. Using the provided bolts, stock nuts and provided gasket install the front axle-back pipe and slide into the rubber isolation mount
7. Install the Takeda y-pipe section and 3" band clamp onto the axle back pipe.
8. Install the Takeda tail pipe driver and passenger side using the provided clamp and slide into rubber isolation mounts.
9. Install Takeda tips using the provided clamps and slide onto tail pipe section.
10. Ensure that all the components of the aFe POWER exhaust system are aligned and are at a safe clearance from all wires, hoses, brake lines, body parts, and tires.
11. Start from the front of the aFe exhaust system and evenly tighten all clamps and fasteners.
12. Start the vehicle and check for any leaks. If any leaks are found, determine cause and repair as necessary.
13. Remove vehicle from jacks stands.
14. It is recommended to re-tighten all clamps and hardware after 50-100 miles.